

Marine Roofs 80-100 Series

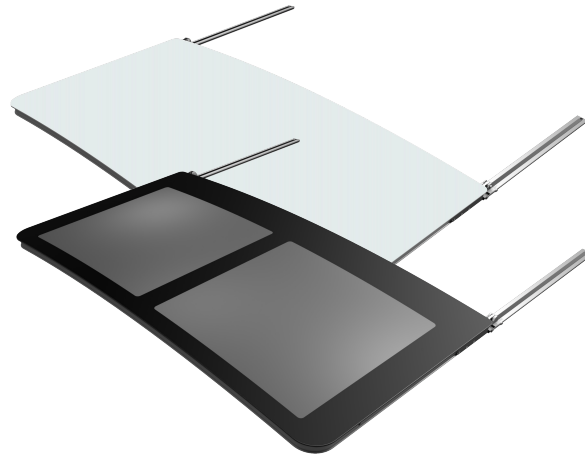

Operating Instructions

Marine Roof

Table of Contents

1	About this Document	EN-1	4.1	Opening the Roof	EN-2
1.1	Purpose of the Document	EN-1	4.2	Closing the Roof	EN-2
1.2	Using the Document	EN-1	5	Maintenance	EN-3
1.3	Use of Symbols and Highlighting	EN-1	6	Troubleshooting	EN-3
1.4	Warranty	EN-1	7	Closing Roof Manually	EN-4
2	Safety	EN-2	8	Reset Procedure	EN-4
2.1	Intended use	EN-2	9	Declarations of conformity	EN-4
2.2	Safety Information	EN-2			
3	Overview of Roof	EN-2			
4	Operation	EN-2			

1 About this Document

1.1 Purpose of the Document

These operating instructions are part of the product and provide the user with information on the safe operation of the unit.

1.2 Using the Document

- ▶ Before operating the roof, carefully read these operating instructions.
- ▶ Keep these operating instructions in the vessel.
- ▶ Hand these operating instructions on to the following owner or user of the unit.

1.3 Use of Symbols and Highlighting



WARNING

Type and source of danger

Result: non-observance can lead to severe or mortal injuries.

- ▶ Actions to protect yourself against risks.



CAUTION

Type and source of danger

Result: non-observance leads to minor injuries.

- ▶ Actions to protect yourself against risks.



ATTENTION

Type and source of danger

Result: non-observance leads to property damage.

- ▶ Actions to protect yourself against risks.



Note on a special technical feature

Highlight	Explanation
✓	Requirements for the following necessary action
▶	Necessary action

1.4 Warranty

Webasto guarantees the quality and correct operation of this marine roof. The limited warranty covers both parts and labour and is valid for 3 years after date of first delivery of the boat.

Warranty starts at the invoice date of the vessel to the first end customer, or maximum 12 months after Webasto invoice date.

The warranty applies only when the sliding roof has been installed by a Webasto authorised shipyard or installer and in accordance with Webasto installation instructions.

Defects and malfunctions caused by incorrect handling, misuse, lack of reasonable and necessary maintenance, accident and broken panels are not covered by this warranty.

The warranty is only valid when proof of purchase can be provided.

2 Safety

2.1 Intended use

The marine roofs are meant to provide more light and fresh air on board.

2.2 Safety Information



ATTENTION

Possible damage due to weather conditions and/or speed

Close the roof at:

- ▶ Speeds of above 30 kts.
- ▶ A sea state of more than 1 m.
- ▶ At wind speeds of more than 16 kts.



WARNING

Entrapment by closing the roof

Injuries or suffocation.

- ▶ When closing the roof, ensure to keep all body parts and/or obstructions away from the marine roof opening.



CAUTION

Using the roof as escape hatch

Risk of injury and/or damage of components of the roof.

- ▶ Do not use the roof as an escape hatch.



ATTENTION

Standing or walking on the roof

Damage of components of the roof.

- ▶ Do not stand or walk on the roof.



Keep the emergency key in close proximity of the roof for manual operation.

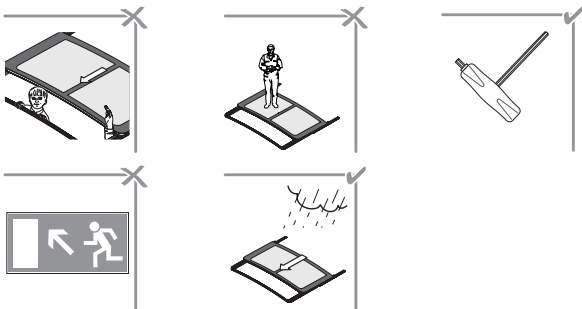

3 Overview of Roof

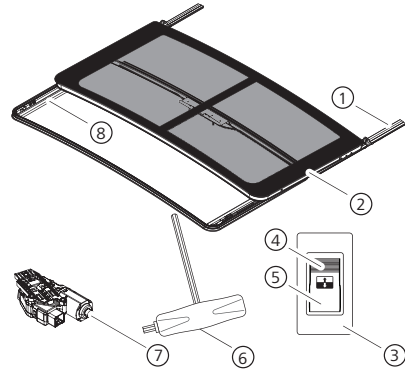

- | | |
|----------------|-----------------|
| 1 Rails | 5 Open button |
| 2 Panel | 6 Emergency key |
| 3 Switch | 7 Motor |
| 4 Close button | 8 Guides |

4 Operation

Within the range of *closed position* and *open position*, the panel can be positioned randomly.

4.1 Opening the Roof



ATTENTION

Opening the roof with water on top

Water intrusion into the cabin.

- ▶ Clear any standing water from the panel prior to operation.

The roof opens as long as the button is pressed.

- ✓ Main power supply is switched on.

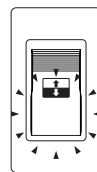

- ▶ Push and hold the open button to open the roof.
- ▶ Release the button when the roof has reached the desired position.

4.2 Closing the Roof

The roof closes as long as the button is pressed.

- ✓ Main power supply is switched on.

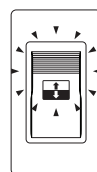

- ▶ Push and hold the close button to close the roof.
- ▶ Release the button when the roof has reached the desired position.

5 Maintenance



ATTENTION

Cleaning agents can contain harmful components

Damage to product.

- ▶ Never use solvents such as:
 - Methylated spirits
 - Turpentine
 - White spirit
 - Window cleaning products
 - Alkaline products containing sodium solutions
 - Acid products like muriatic or those containing phosphor

- ▶ Clean the roof regularly.
- ▶ Wash the panel with clean water and a soft cloth, chamois leather or sponge.



ATTENTION

Dry materials causing scratches

Scratches or damage on the roof.

- ▶ Never rub the dry surface of the roof.
- ▶ Never use steel wool, abrasives or sandpaper.

- ▶ Wash the remainder of the roof with lukewarm water with a professional marine cleaning product.
- ▶ Rinse with clean water.
- ▶ Apply a thin layer of grease (Isoflex® Topas L32) to the inside of the rails and guides to ensure smooth sliding.

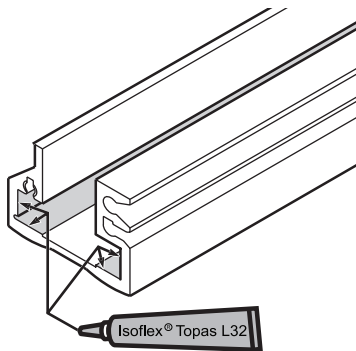

Fig. 01: Greasing guides

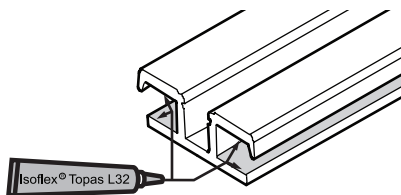

Fig. 02: Greasing rails

6 Troubleshooting

Symptom	Possible causes	Solution
Poor opening of the roof	Pollution of rubber seal.	▶ Clean seal with mild detergent
Poor sliding of the roof	Lack of grease on the rails and guides	▶ Clean and apply grease to inside of rails and guides
Roof does not slide smoothly after cleaning and greasing		▶ Contact supplier
Roof does not open / close	No Power	▶ Check battery
	Broken fuse	▶ Replace fuse
Roof does not close	Motor does not operate properly	▶ Close roof manually as described in chapter 7 ▶ Contact supplier



ATTENTION

Motor does not respond as expected

Improper functioning of roof.

- ▶ Reset control system after operating roof manually.
- ▶ Read chapter "Reset procedure".

7 Closing Roof Manually

Close the roof manually as follows:

- ▶ Disconnect the wiring harnesses from the motors.

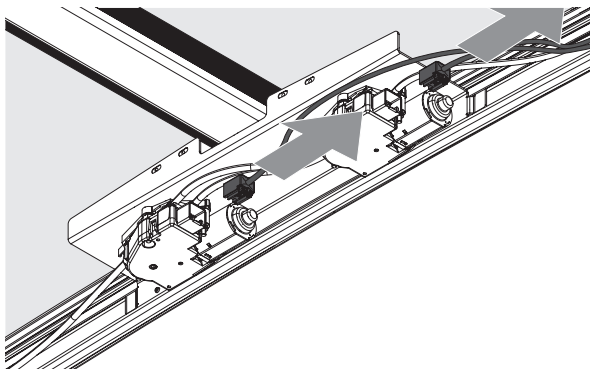

Fig. 03: Disconnect wiring harnesses

- ▶ Remove 3 hex bolts at each motor with the emergency key.
- ▶ Remove the motors.

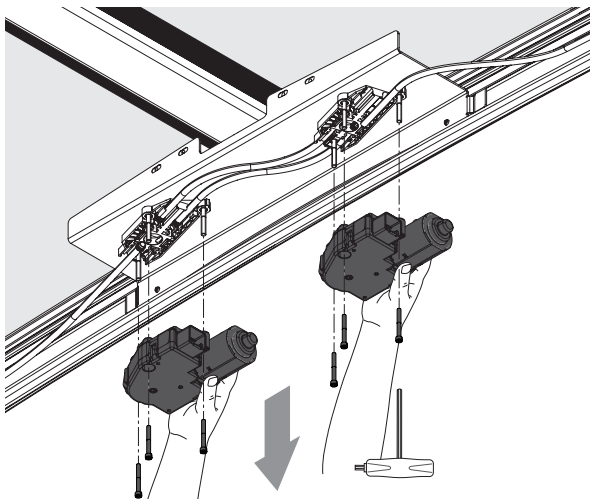

Fig. 04: Remove motors

- ▶ Close the roof manually by pushing the glass panel towards the close position at the front.

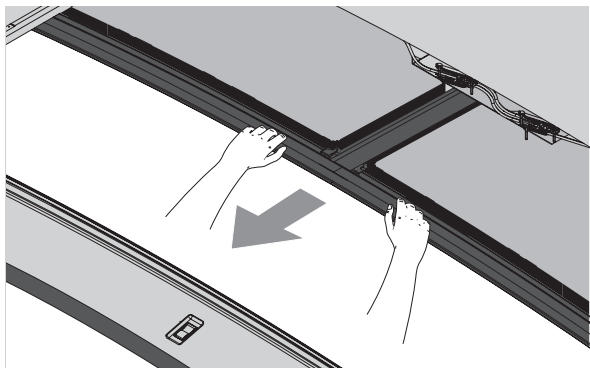

Fig. 05: Closing the roof



WARNING

Entrapment by closing the roof

Injuries or suffocation.

The glass panel will sink by itself using its own weight in the top frame.

- ▶ When closing the roof, ensure to keep all body parts and/or obstructions away from the marine roof opening.

8 Reset Procedure

- ✓ There is a minimum of 40 A available.

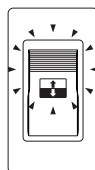

- ▶ Press and hold close button.

The roof closes as far as possible.

- ▶ Release close button.

- ▶ Press and hold close button.

After approx. 10 seconds roof slides with small steps until it is completely closed.

Motor produces a loud click sound.

- ▶ Release close button.

The system has been reset.

9 Declarations of conformity

See „Annex“ on page ANNEX-1.

Annex

EU-Konformitätserklärung EC-Declaration of Conformity



Hersteller Webasto Thermo & Comfort Benelux BV

Manufacturer Constructieweg 47
8263 BC Kampen
The Netherlands

Für die Verwendung des Webasto Schiebedachsystems
For the use of the Webasto sunroof system

Marine Roof 80 and 100-Series

Richtlinie	Harmonisierte Normen
Directive	Harmonised Standards
2014/30/EU EMV	EN 60945:2002
2014/30/EU EMC	
2013/53/EU 2013/53/EU recreational craft and personal watercraft Directive	EN ISO 12216:2018

Notified Body for 2013/53/EU 0614

Ort und Datum der Ausstellung Kampen, den 16.10.2024
Place and Date of issue

ppa

i.A.

D. van Dort
Managing Director
Webasto Thermo & Comfort Benelux

J. Belz
Certification & Compliance Expert
Webasto Roof & Components SE

Original in deutscher Fassung.
Original in German version.

Die alleinige Verantwortung für die Ausstellung dieser
This declaration of conformity is issued under the sole responsibility of



**UK-Konformitätserklärung
UK-Declaration of Conformity**



Hersteller Webasto Thermo & Comfort Benelux BV
Manufacturer Constructieweg 47
8263 BC Kampen
The Netherlands

**Für die Verwendung des Webasto Schiebedachsystems
For the use of the Webasto sunroof system**

Marine roof 80 and 100-Series

Richtlinie	Harmonisierte Normen
Directive	Designated Standards
Electromagnetic Compatibility Regulations 2016	EN 60945:2002
Recreational Craft Regulations 2017	EN ISO 12216:2018

**Ort und Datum der Ausstellung
Place and Date of issue**

Kampen, den 16.10.2024

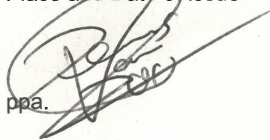
ppa.

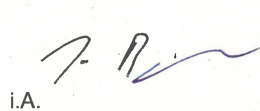
i.A.

D. van Dort
Managing Director
Webasto Thermo & Comfort Benelux

J. Belz
Certification & Compliance Expert
Webasto Roof & Components SE

**Original in deutscher Fassung.
Original in German version.**

**Die alleinige Verantwortung für die Ausstellung dieser
This declaration of conformity is issued under the sole responsibility of**

To request this documentation in another language, please locate and contact your local Webasto dealer.
You can find your nearest dealer at: <https://dealerlocator.webasto.com/en-int>.
To provide feedback (in English or German), please email: feedback2tdt@webasto.com

Benötigen Sie diese Dokumentation in einer anderen Sprache, wenden Sie sich bitte an Ihren örtlichen Webasto Händler.
Sie finden den nächstgelegenen Händler unter: <https://dealerlocator.webasto.com/de-de>.
Um Feedback (in Englisch oder Deutsch) zu geben, senden Sie bitte eine E-Mail an: feedback2tdt@webasto.com

Als u deze documentatie in een andere taal nodig hebt, neemt u contact op met uw plaatselijke Webasto-dealer.
De dichtstbijzijnde dealer vindt u via: <https://dealerlocator.webasto.com/nl-nl>.
Om feedback (in het Engels of Duits) over dit document te geven, stuurt u een e-mail naar het Tech Doc / Translation team: feedback2tdt@webasto.com

Si vous avez besoin de cette documentation dans une autre langue, veuillez vous adresser à votre revendeur local Webasto. Vous trouverez le revendeur le plus proche de chez vous sur : <https://dealerlocator.webasto.com/fr-fr>.
Pour donner votre avis (en anglais ou en allemand) sur ce document, veuillez envoyer un e-mail au : feedback2tdt@webasto.com

Se la presente documentazione è necessaria in un'altra lingua, rivolgersi al proprio rivenditore locale Webasto.
Per trovare il rivenditore più vicino fare riferimento all'indirizzo: <https://dealerlocator.webasto.com/it-it>.
Per fornire un feedback (in inglese o tedesco) in merito al presente documento, inviare un messaggio di posta elettronica al team Tech Doc e Translation: feedback2tdt@webasto.com

Europe, Asia Pacific

Webasto
Kraillinger Str. 5
82131 Stockdorf
Germany

Only within Germany
Tel: 0395 5592 444
Mail: technikcenter@webasto.com

UK only

Webasto Thermo & Comfort UK Ltd
Webasto House
White Rose Way
Doncaster Carr
South Yorkshire
DN4 5JH
United Kingdom